

Cavity wall lintels - Standard duty

CA16 range

CA16 Lintels are economic, standard duty cavity wall lintels suitable for moderate spans where they are required to support only the masonry immediately above, and perhaps a typical timber floor.

Specification table for CA16 Lintels

Nominal cavity size (mm)	Nominal inner leaf (mm)	SPECIFY	Overall Height (mm)	Overall Width (mm)	Steel Gauge (mm)	Mass (kg/m)	Form Type	Ixx (cm ⁴)	Zxx (cm ³)
47-56	100-115	CA16-100/50/100	176	242	2.0	8.5	1	384.9	32.62
	125-140	CA16-100/50/125	176	267	2.0	8.9	1	400.7	33.39
	190-215	CA16-100/50/190	178	317	2.0	12.6	2	509.0	37.15
57-71	100-115	CA16-100/60/100	176	252	2.0	8.5	1	382.7	32.71
	125-140	CA16-100/60/125	176	277	2.0	8.9	1	398.4	33.48
	190-215	CA16-100/60/190	178	342	2.0	12.8	2	511.2	37.31
72-84	100-115	CA16-100/75/100	173	266	2.0	8.5	1	370.8	32.24
	125-140	CA16-100/75/125	173	292	2.0	8.9	1	386.1	32.72
	190-215	CA16-100/75/190	175	356	2.0	13.0	2	501.6	36.88
85-96	100-115	CA16-100/90/100	171	280	2.0	8.6	1	362.6	31.81
	125-140	CA16-100/90/125	171	305	2.0	8.9	1	374.7	32.03
	190-215	CA16-100/90/190	173	370	2.0	13.1	2	486.6	36.31
97-119	100-115	CA16-100/100/100	168	292	2.0	8.6	1	349.8	31.23
	125-140	CA16-100/100/125	168	317	2.0	8.9	1	364.2	31.95
	190-215	CA16-100/100/190	170	382	2.0	13.4	2	478.5	35.98
120-139	100-115	CA16-100/120/100	167	315	2.0	8.9	3	372.0	34.77
	125-140	CA16-100/120/125	167	340	2.0	9.3	3	388.4	35.31
	190-215	CA16-100/120/190	169	405	2.0	14.2	4	532.6	40.97
140-160	100-115	CA16-100/140/100	167	335	2.0	9.2	3	385.4	36.36
	125-140	CA16-100/140/125	167	360	2.0	9.6	3	402.7	37.29
	190-215	CA16-100/140/190	169	425	2.0	14.6	4	554.8	43.01

NOTES: The lintel form varies over the range (see below). Lintels with form type 1 and 2 do not require a separate DPC, and are supplied complete with stop-ends to form an integral cavity tray. (see pages 78 & 88)

Need a stronger lintel?
See CA19 >

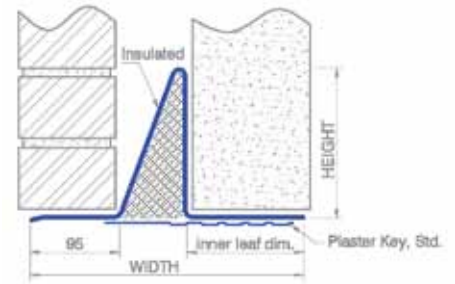

Allowable load for all CA16 Lintels*

Opening Span	Lintel Length	Max total load (kN)*	Load Example (see pg 85)
450	750	37.4	masonry & timber floor
600	900	37.4	
750	1050	37.4	
900	1200	37.4	
1050	1350	37.4	
1200	1500	37.4	
1350	1650	37.4	
1500	1800	37.4	
1650	1950	34.3	
1800	2100	31.6	
1950	2250	29.4	
2100	2400	27.4	full height masonry
2250	2550	25.7	
2400	2700	24.2	
2550	2850	22.9	
2700	3000	20.5	
2850	3150	18.4	
3000	3300	16.6	440mm of masonry
3150	3450	15.0	
3300	3600	13.7	
3450	3750	12.5	

Intermediate sizes can be produced

Permissible Moment*: 4.3 kN.m

Permissible Point Load*: 4.1 kN

LOAD RATIO LIMITS* (OUTER : INNER)

65-100% Max load: 1:1 - 1:3 OR < 65% Max Load: 2:1 - 1:5

*See page 78 for loading & Installation guide

STANDARD VARIATIONS OF ALL CA-TYPE LINTELS

FORM TYPE 1

Standard form for Cavity sizes up to 120mm and moderate inner leaf widths (No separate DPC required if over 150mm high).

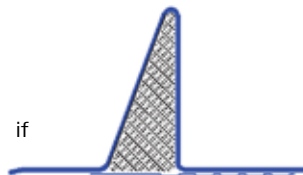

FORM TYPE 3

Form type 1 with an additional bend in the outer web to maintain strength over the wider cavity.

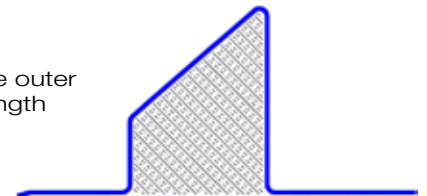

FORM TYPE 2

Form type 1 with an extra plate on the base to support a wide inner leaf and resist associated rotation,

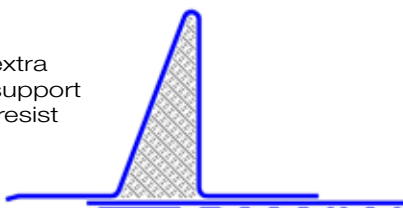

FORM TYPE 4

Form type 3 with an extra plate on the base to support a wide inner leaf and resist associated rotation,

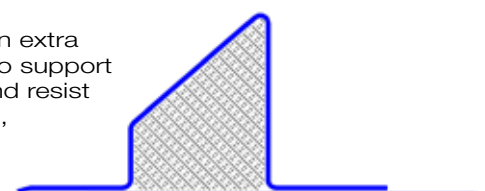

Many variations are possible, including bolted connections & other specially fabricated features - All standard in LDX2101@ Stainless Steel. Call 01206 79 2001 to discuss or visit www.stainless-lintels.co.uk